

# ABELL SURVEYING & MAPPING

LOT 14 1140 SEQUOIA STREET • DELAVAN, WISCONSIN 53115  
414-728-6737

NOTE: BEARINGS ARE REFERENCED TO THE  
RECORDED SUBDIVISION PLAT.

N



SCALE 1"=30'

## LEGEND

- - IRON ROD FOUND
- - UTILITY PED.
- XX - CHAINLINK FENCE
- \* - WOOD FENCE
- ( ) - RECORDED AS

ORDERED BY: SLAWOMIR KOSSAKOWSKI  
6066 N. FOREST GLEN  
CHICAGO, IL 60746

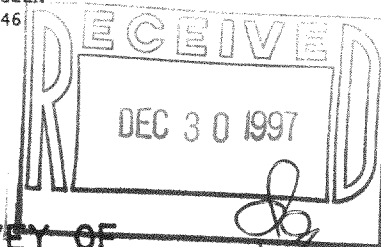

## PLAT OF SURVEY OF

LOT 15, PINE KNOLLS SUBDIVISION, LOCATED  
IN T4N, R15E, WALWORTH COUNTY, WISCONSIN.

I HEREBY CERTIFY THAT I HAVE SURVEYED THE ABOVE DESCRIBED PROPERTY AND THAT THE ABOVE MAP IS A TRUE REPRESENTATION THEREOF AND SHOWS THE SIZE AND LOCATION OF THE PROPERTY, ITS EXTERIOR BOUNDARIES, THE LOCATION OF ALL VISIBLE STRUCTURES AND DIMENSIONS OF ALL PRINCIPAL BUILDINGS THEREON, BOUNDARY FENCES, APPARENT EASEMENTS, ROADWAYS AND VISIBLE ENCROACHMENTS, IF ANY, TO THE BEST OF MY KNOWLEDGE AND BELIEF.

THIS SURVEY IS MADE FOR THE USE OF THE PRESENT OWNERS OF THE PROPERTY, AND ALSO THOSE WHO PURCHASE, MORTGAGE, OR GUARANTEE THE TITLE THERETO WITHIN ONE (1) YEAR FROM DATE HEREON.

*David F. Abell*

DAVID F. ABELL  
WISCONSIN REGISTERED LAND SURVEYOR, S-1596

*November 18, 1997*

DATE JOB NUMBER - 97218  
NOTE: THIS IS NOT A CERTIFIED COPY UNLESS SEALED.

PINE KNOLLS DRIVE

6' 6"

(S 1°42' W 200.00')  
N 01°43' 31" E 200.09'

GRAVEL DRIVE

LOT 15  
AREA 1.03 ACRES □ WELL O

116.2'

N 88°16'59"W 225.11'

(S 88°18' E 225.00')

LOT 16

S 88°18'00"E 225.05' (225.00')

10'

EASEMENT  
S 01°42' 28" W 200.16'  
(S 1°42' W 200.00')

10'

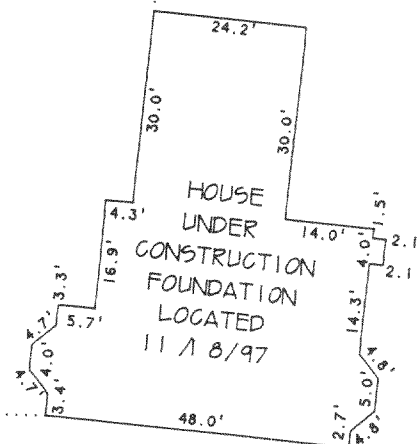

415-629  
DPK-15